

Combination Chains

A1 Attachment

Drawing no. 118

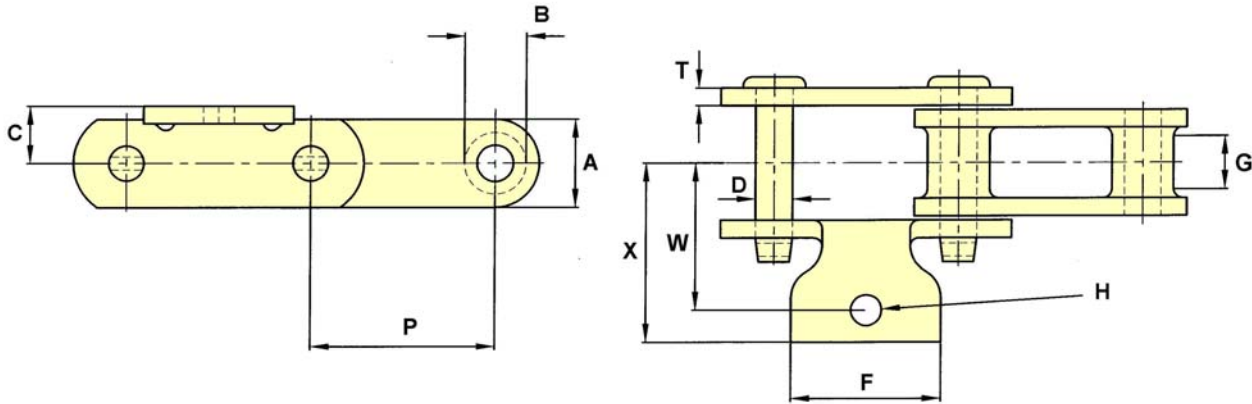

CHAIN NO.	PITCH P	ALLOW. LOAD	U.T.S.	PIN DIA. D	SIDEBAR DEPTH A	MAX GEARING G	BARREL DIA. B	C	F	BOLT DIA. H	T	W	X
C188	2.609	2,000	17,500	0.50	1.25	0.75	0.87	0.81	2.13	0.38	0.25	1.88	2.56

ATTACHMENTS ARE ONLY AVAILABLE ON THE OUTER LINK
C188 IS A ROUND BARREL DESIGN

Combination Chains

A2 Attachment

Drawing no. 120

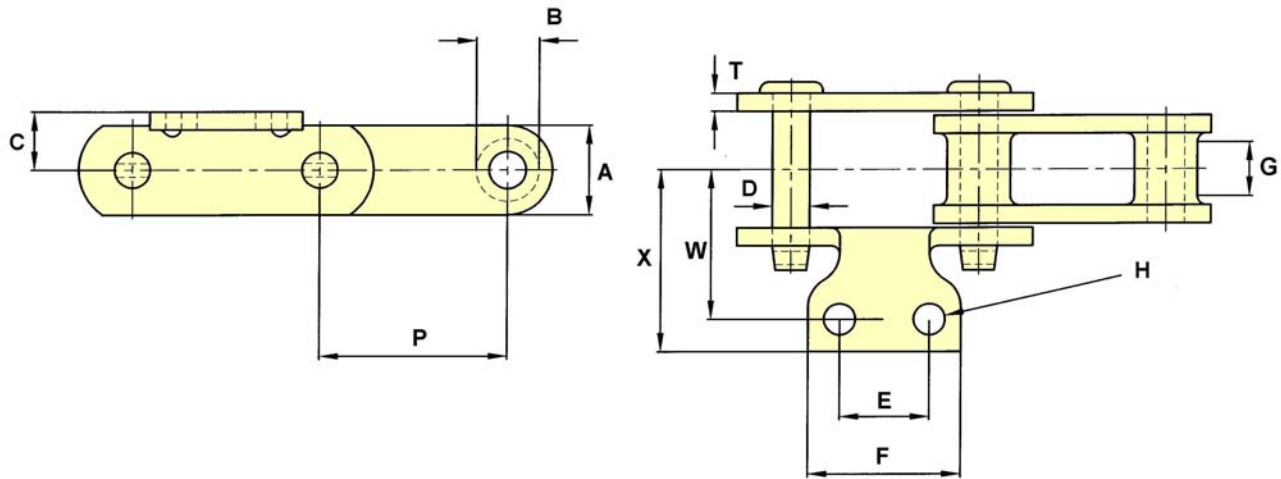

CHAIN NO.	PITCH P	ALLOW. LOAD	U.T.S.	PIN DIA. D	SIDEBAR DEPTH A	MAX GEARING G	BARREL DIA. B	C	E	F	BOLT DIA. H	T	W	X
C188	2.609	2,000	17,500	0.50	1.25	0.75	0.87	0.81	1.25	2.13	0.38	0.25	2.09	2.56
C131	3.075	3,220	27,500	0.62	1.50	1.13	1.25	1.00	1.50	2.63	0.50	0.38	2.06	2.63
C102B	4.000	4,200	27,500	0.62	1.50	1.75	1.00	1.00	1.75	2.69	0.38	0.38	2.66	3.33

- ATTACHMENTS ARE ONLY AVAILABLE ON THE OUTER LINK
- C188 IS A ROUND BARREL DESIGN

Combination Chains

A1. 1/2 Attachment

Drawing no. 141

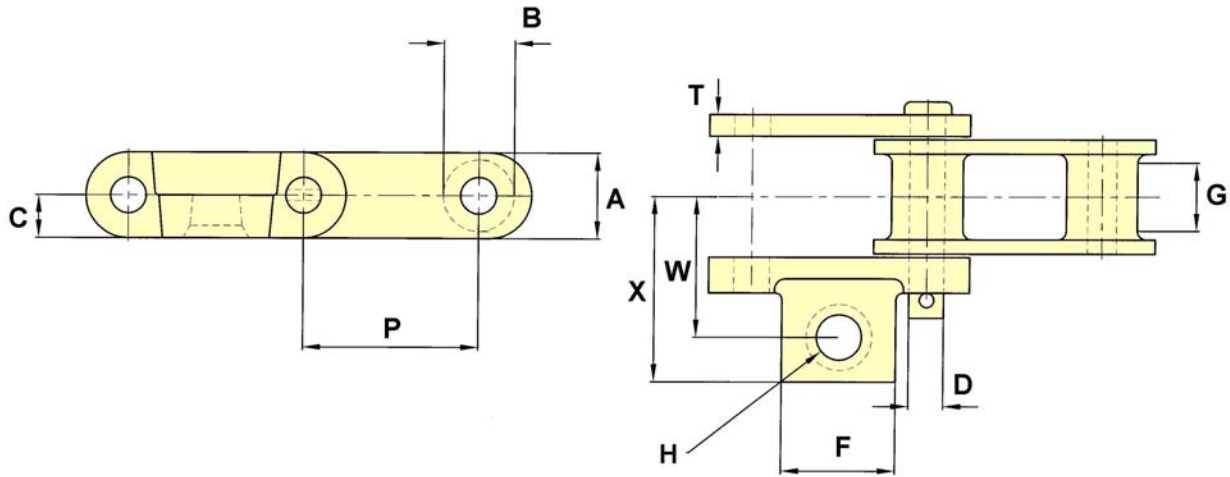

CHAIN NO.	PITCH P	ALLOW. LOAD	U.T.S.	PIN DIA. D	SIDEBAR DEPTH A	MAX GEARING G	BARREL DIA. B	C	F	BOL DIA. H	T	W	X
C131	3.075	3,220	27,500	0.62	1.50	1.13	1.25	0.75	2.00	0.75	0.38	2.44	3.22

NORMALLY SUPPLIED WITH ROUND BARREL DESIGN

Combination Chains

F2 Attachment

Drawing no. 142

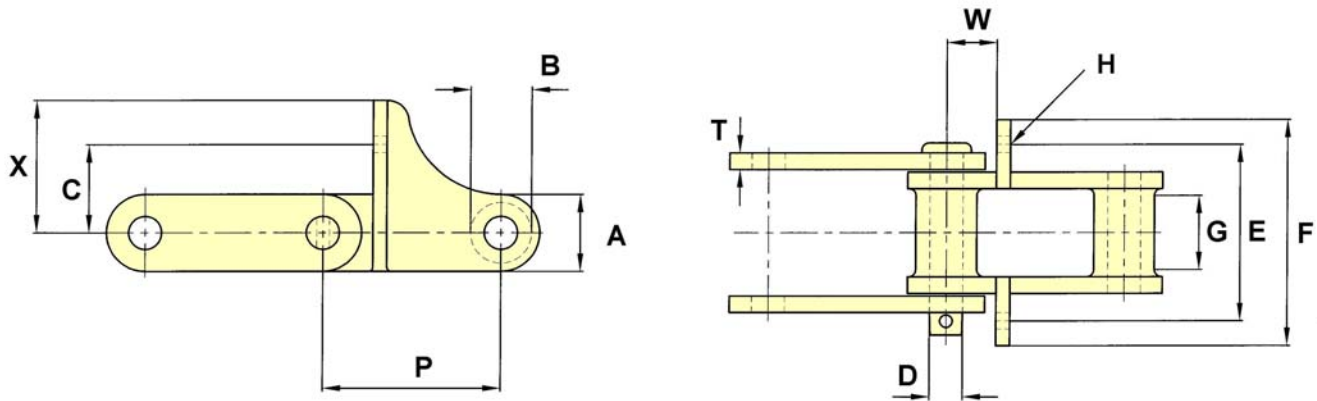

CHAIN NO.	PITCH P	ALLOW. LOAD	U.T.S.	PIN DIA. D	SIDEBAR DEPTH A	MAX GEARING G	BARREL DIA. B	C	E	F	BOL DIA. H	T	W	X
C1021/2	4.040	5,550	36,000	0.75	1.75	2.00	1.38	2.00	4.00	5.13	0.38	0.38	1.13	3.00

Combination Chains

AS20 Attachment

Drawing no. 27

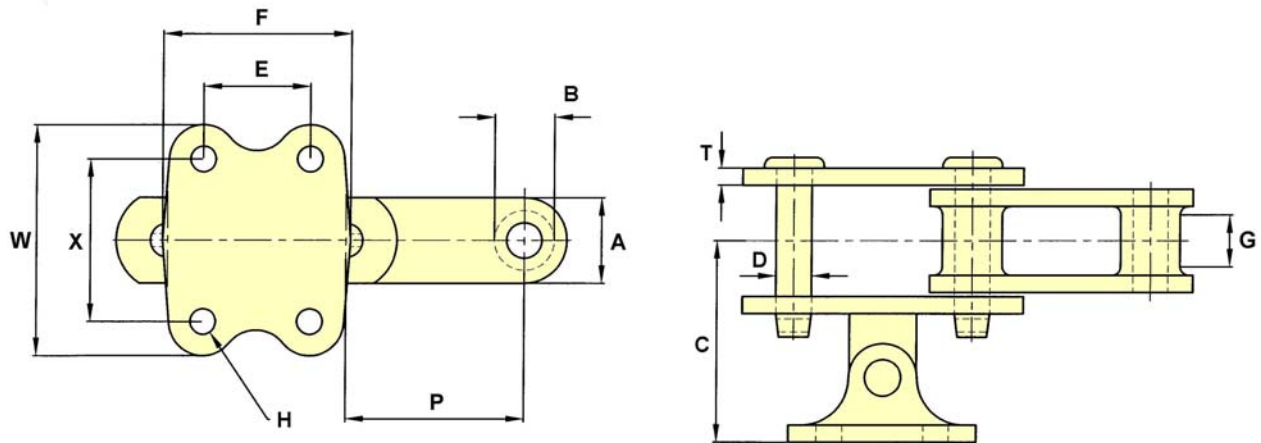

CHAIN NO.	PITCH P	ALLOW. LOAD	U.T.S.	PIN DIA. D	SIDEBAR DEPTH A	MAX GEARING G	BARREL DIA. B	C	E	F	BOLT DIA. H	W	X
C188	2.609	2,000	17,500	0.50	1.25	0.75	0.87	2.94	1.56	2.75	0.31	3.19	2.19
C131	3.075	3,220	27,500	0.62	1.50	1.13	1.25	3.47	1.69	3.13	0.31	3.50	2.44
C102B	4.000	4,200	27,500	0.62	1.50	1.75	1.00	3.89	1.69	3.13	0.31	3.50	2.44
C111	4.760	6,000	36,000	0.75	1.75	2.25	1.44	4.72	2.50	3.75	0.50	4.25	3.00
C110	6.000	4,200	27,500	0.62	1.50	1.75	1.25	4.25	2.50	4.00	0.38	3.50	2.25

**ATTACHMENTS ARE ONLY AVAILABLE ON THE OUTER LINK
C188 IS A ROUND BARREL DESIGN**

Combination Chains

K1 Attachment

Drawing no. 35

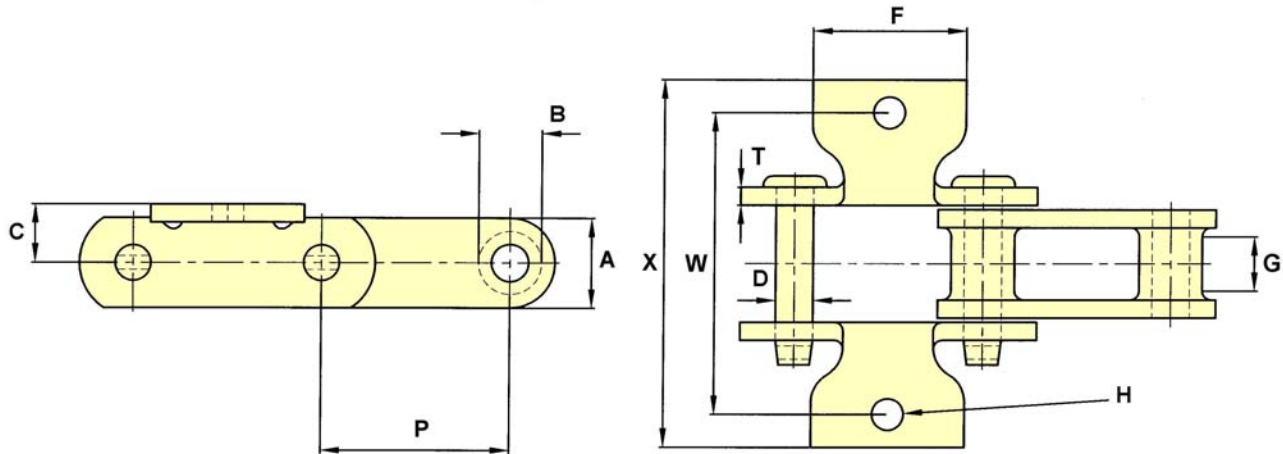

CHAIN NO.	PITCH P	ALLOW. LOAD	U.T.S.	PIN DIA. D	SIDEBAR DEPTH A	MAX GEARING G	BARREL DIA. B	C	F	BOLT DIA. H	T	W	X
C55	1.631	1,400	12,150	0.38	0.75	0.69	0.72	0.50	0.81	0.25	0.19	2.03	2.91
C188	2.609	2,000	17,500	0.50	1.25	0.75	0.87	0.81	2.13	0.38	0.25	3.75	5.13

C188 = ATTACHMENTS ARE ONLY AVAILABLE ON THE OUTER LINK

C55 = ATTACHMENTS ARE ONLY AVAILABLE ON THE INNER LINK

ROUND BARREL DESIGN

Combination Chains

K2 Attachment

Drawing no. 40

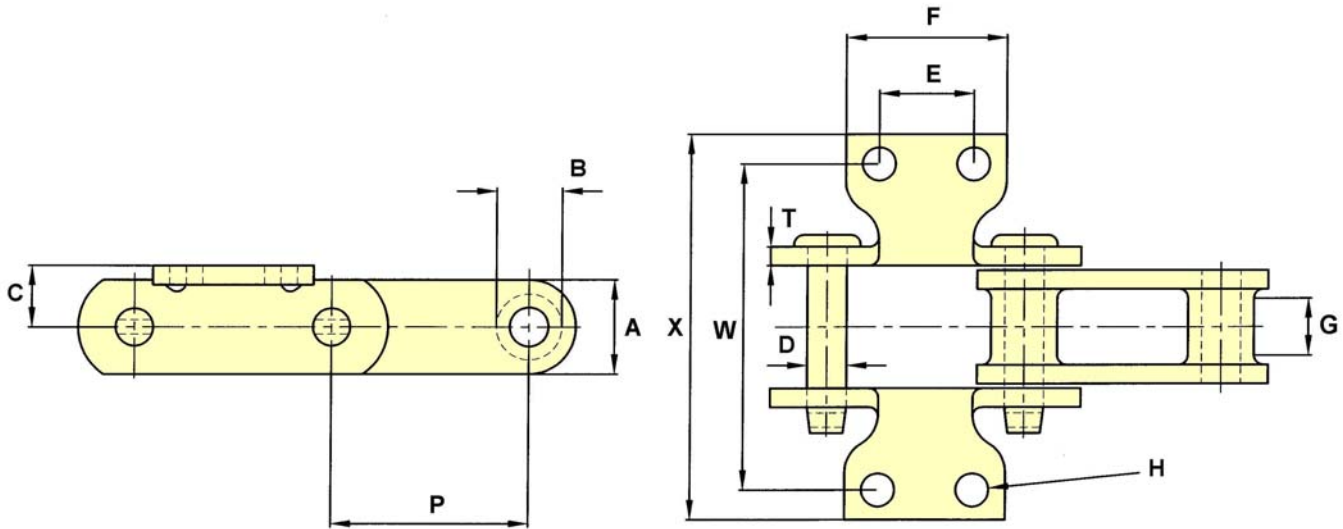

CHAIN NO.	PITCH P	ALLOW. LOAD	U.T.S.	PIN DIA. D	SIDEBAR DEPTH A	MAX GEARING G	BARREL DIA. B	C	E	F	BOLT DIA. H	T	W	X
C188	2.609	2,000	17,500	0.50	1.25	0.75	0.87	0.81	1.25	2.13	0.38	0.25	4.19	5.13
C131	3.075	3,220	27,500	0.62	1.50	1.13	1.25	1.00	1.50	2.63	0.50	0.38	4.13	5.25
C102B*	4.000	4,200	27,500	0.62	1.50	1.75	1.00	1.00	1.75	2.69	0.38	0.38	5.31	6.66
C1021/2	4.040	5,550	36,000	0.75	1.75	2.00	1.38	1.00	1.75	2.81	0.50	0.38	5.31	6.50
C111	4.760	6,000	36,000	0.75	1.75	2.25	1.44	1.13	2.31	3.63	0.38	0.38	6.25	7.50
C110	6.000	4,200	27,500	0.62	1.50	1.75	1.25	1.00	1.75	2.87	0.38	0.38	5.31	6.69
C132	6.050	10,000	60,000	1.00	2.00	2.88	1.72	1.25	2.75	4.00	0.50	0.50	7.50	9.18

* = K2 ATTACHMENTS FOR CENTRE LINK ARE ONLY AVAILABLE ON C102B AND C1021/2

* = C188 IS A ROUND BARREL DESIGN

Combination Chains

G4 Attachment

Drawing no. 29

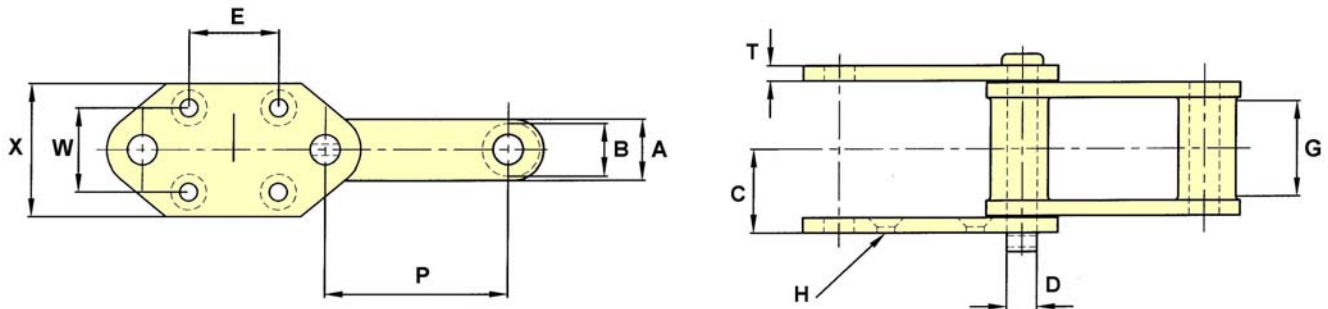

CHAIN NO.	PITCH P	ALLOW. LOAD	U.T.S.	PIN DIA. D	SIDEBAR DEPTH A	MAX GEARING G	BARREL DIA. B	C	E	BOLT DIA. H	T	W	X
C132	6.050	10,000	60,000	1.00	2.00	2.88	1.72	2.72	75MM	15MM	0.50	70MM	4.38

Combination Chains

Wing Attachments

Integral Wing

Drawing no. 143

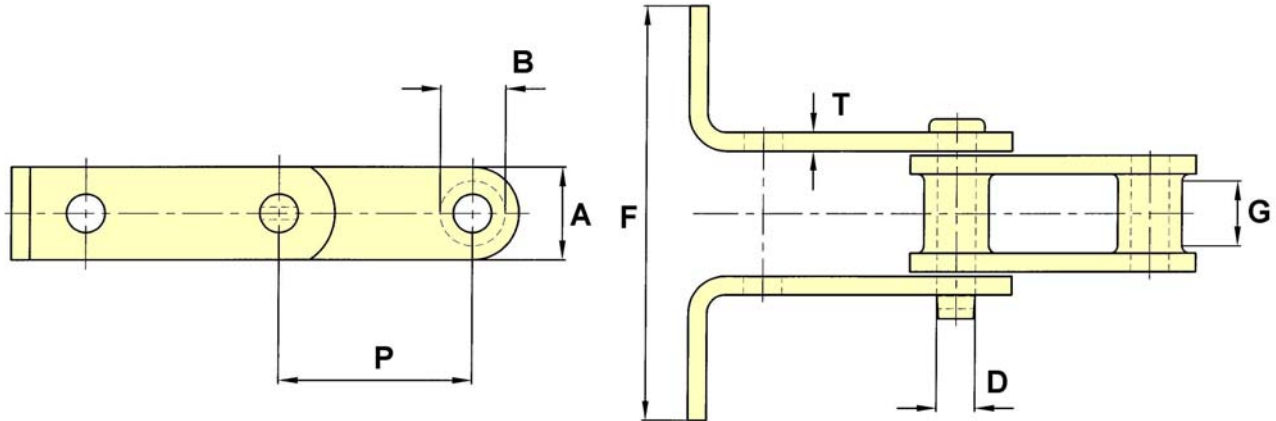

CHAIN NO.	PITCH P	ALLOW. LOAD	U.T.S.	PIN DIA. D	SIDEBAR DEPTH A	MAX GEARING G	BARREL DIA. B	F	T
C188	2.609	2,000	17,500	0.50	1.25	0.75	0.87	*	0.25

NOTE: C188 IS A ROUND BARREL DESIGN
 * THIS DIMENSION CAN BE VARIABLE TO SUIT INDIVIDUAL REQUIREMENTS

Combination Chains

Wing Attachments

'T' Wing Attachment

Drawing no. 140

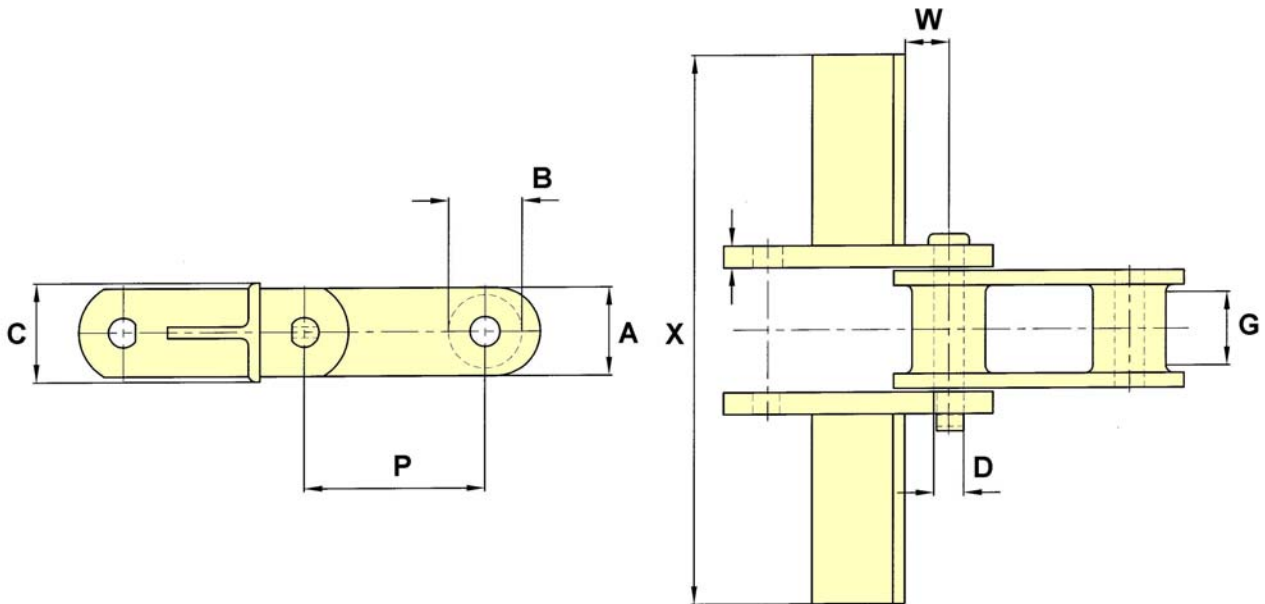

CHAIN NO.	PITCH P	ALLOW. LOAD	U.T.S.	PIN DIA. D	SIDEBAR DEPTH A	MAX GEARING G	BARREL DIA. B	C	T	W	X
C131	3.075	3,220	27,500	0.62	1.50	1.13	1.25	40MM	0.38	0.75	*

NOTE;
* USUALLY SUPPLIED AS ROUND BARREL DESIGN
THIS DIMENSION CAN BE VARIABLE TO SUIT INDIVIDUAL REQUIREMENTS

Combination Chains

S1 Attachments

Drawing no. 50

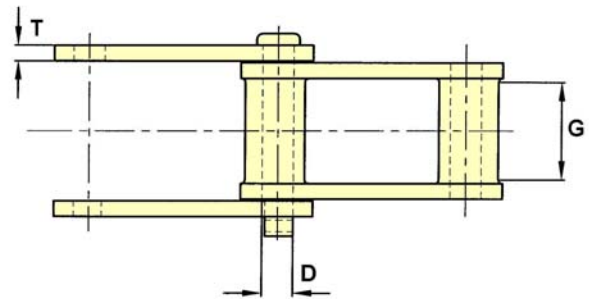
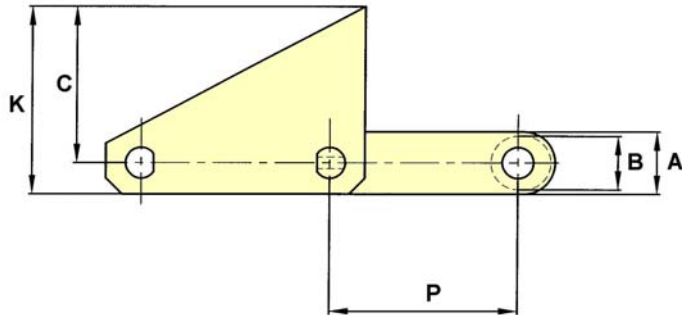

CHAIN NO.	PITCH P	ALLOW. LOAD	U.T.S.	PIN DIA. D	SIDEBAR DEPTH A	MAX GEARING G	BARREL DIA. B	C	K	T
C131	3.070	3,220	27,500	0.62	1.50	1.13	1.25	3.25	4.00	0.38
C102B	4.000	4,200	27,500	0.62	1.50	1.75	1.00	3.75	4.50	0.38
C111	4.760	6,000	36,000	0.75	1.75	2.25	1.44	4.38	5.25	0.38
C110	6.000	4,200	27,500	0.62	1.50	1.75	1.25	4.25	5.00	0.38
C132	6.050	10,000	60,000	1.00	2.00	2.88	1.72	5.00	6.00	0.50
C132	6.050	10,000	60,000	1.00	2.00	2.88	1.72	8.00	9.00	0.50
C132	6.050	10,000	60,000	1.00	2.00	2.88	1.72	10.00	11.00	0.50